



# DIMENSIONS™



DC  
COMICS™

71210

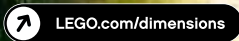

This device complies with part 15 of the FCC Rules. Operation is subject to the following two conditions:

(1) This device may not cause harmful interference, and (2) this device must accept any interference received, including interference that may cause undesired operation.

This device should be installed and operated with a minimum distance of 20 cm to your body.

NOTE: This equipment has been tested and found to comply with the limits for a Class B digital device, pursuant to part 15 of the FCC Rules. These limits are designed to provide reasonable protection against harmful interference in a residential installation. This equipment generates, uses and can radiate radio frequency energy and, if not installed and used in accordance with the instructions, may cause harmful interference to radio communications. However, there is no guarantee that interference will not occur in a particular installation. If this equipment does cause harmful interference to radio or television reception, which can be determined by turning the equipment off and on, the user is encouraged to try to correct the interference by one or more of the following measures:

- Reorient or relocate the receiving antenna.
- Increase the separation between the equipment and receiver.
- Connect the equipment into an outlet on a circuit different from that to which the receiver is connected.
- Consult the dealer or an experienced radio/TV technician for help.

Caution: changes or modifications not expressly approved by the party responsible for compliance could void the user's authority to operate the equipment.

This Class B digital apparatus complies with Canadian ICES-003.

Cet appareil numérique de la classes B est conforme à la norme NMB-003 de Canada.

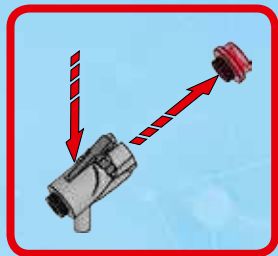
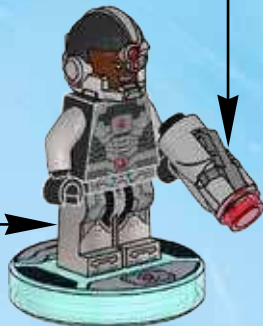
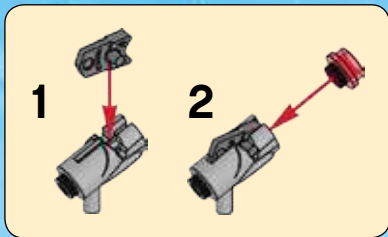
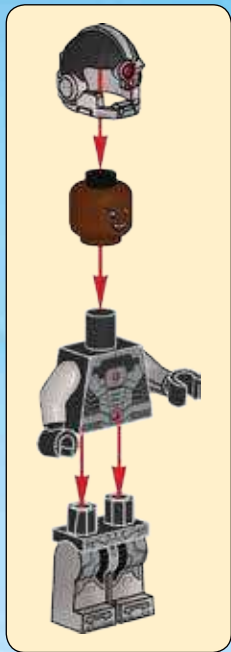

1



+

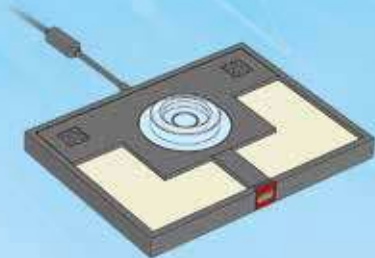

Start game  
Commence le jeu  
Iniciar juego

2

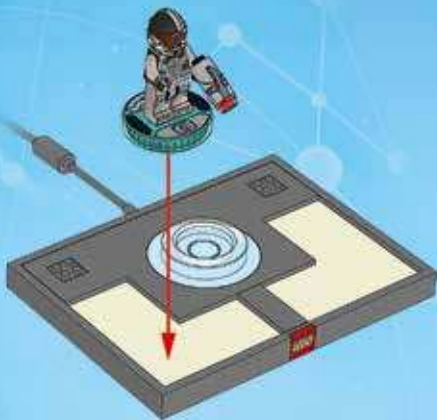

# 3

- Continue building using the in-game building instructions
- Continue à construire en utilisant les instructions de construction figurant dans le jeu
- Sigue construyendo con las instrucciones de construcción incluidas en el juego



# DIMENSIONS™

FUN PACKS  
ENSEMBLES AMUSANTS  
PACKS DE DIVERSIÓN



— 71209 —



— 71210 —



— 71211 —



— 71212 —



— 71213 —



— 71214 —



— 71215 —



— 71216 —



— 71217 —



# DIMENSIONS™

**FUN PACKS**  
**ENSEMBLES AMUSANTS**  
**PACKS DE DIVERSIÓN**



— 71218 —



— 71219 —



— 71220 —



— 71221 —



— 71222 —



— 71223 —



— 71227 —



— 71231 —



— 71232 —



# DIMENSIONS™

LEVEL PACKS  
ENSEMBLES NIVEAUX  
PACKS DE NIVELES

BACK  
TO THE  
FUTURE



71201

THE  
SIMPSONS



71202

PORTAL 2



71203

BBC  
DOCTOR WHO



71204





# DIMENSIONS™

TEAM PACKS  
ENSEMBLES ÉQUIPES  
PACKS DE EQUIPOS



71205

SCOOBY-DOO!



71206

LEGO NINJAGO  
Masters of Spinjitzu



71207



2x  
614126



1x  
4121715



1x  
6105926



1x  
4594238



1x  
4556157



1x  
6105910



2x  
4184169



2x  
6020193



1x  
6081988



2x  
4211489



2x  
4211398



3x  
6089147



1x  
4560174



1x  
6105945



1x  
4178398



1x  
4211440



2x  
4211429



1x  
6066097



2x  
4541191



1x  
6097129



1x  
6104392



2x  
6028813



1x  
4211090



1x  
6051334



2x  
6043639



6x  
3005741



2x  
4211042



1x  
6122878



1x  
6051333



1x  
6097656



1x  
4211094



2x  
6019987

Customer Service  
Service Consommateurs  
Servicio Al Consumidor  
[LEGO.com/dimensions/service](http://LEGO.com/dimensions/service)

LEGO Dimensions Videogame software © 2015 TT Games Ltd. Produced by TT Games under license from the LEGO Group. LEGO, the LEGO logo, NINJAGO, LEGENDS OF CHIMA, the Brick and Knob configurations and the Minifigure are trademarks and/or copyrights of the LEGO Group. ©2015 The LEGO Group. BBC logo © BBC 1996. Doctor Who logo © BBC 2009. Dalek image © BBC/Terry Nation 1963. Cyberman image © BBC/Kit Pedler/Gerry Davis 1966. K-9 image © BBC/Bob Baker/Dave Martin 1977. Licensed by BBC Worldwide Limited. ™ & © Universal Studios and U-Drive Joint Venture. ™ & © 2015 Fox. ™ & © Universal Studios and Amblin. © & ™ Valve. © Turner Entertainment Co. ™ & © WBEI. (s15). ™ & © Hanna-Barbera. (s15). All other trademarks and copyrights are the property of their respective owners. All rights reserved.

Logiciel de jeu vidéo LEGO Dimensions © 2015 TT Games Ltd. Produit par TT Games avec l'autorisation de LEGO Group. LEGO, le logo LEGO, NINJAGO, LEGENDS OF CHIMA, les configurations de la Brique et du Bouton, ainsi que Minifigure sont des marques de commerce ou des droits d'auteur de LEGO Group. ©2015 The LEGO Group. Logo BBC © BBC 1996. Logo Doctor Who © BBC 2009. Image Dalek © BBC/Terry Nation 1963. Image Cyberman © BBC/Kit Pedler/Gerry Davis 1966. K-9 image © BBC/Bob Baker/Dave Martin 1977. Avec autorisation de BBC Worldwide Limited. ™ et © Universal Studios et U-Drive Joint Venture. ™ et © 2015 Fox. ™ et © Universal Studios et Amblin. © et ™ Valve. © Turner Entertainment Co. ™ et © WBEI. (s15). ™ et © de Hanna-Barbera. (s15). Toutes les autres marques de commerce et droits d'auteur sont la propriété de leurs propriétaires respectifs. Tous droits réservés.

LEGO Dimensions Videogame software © 2015 TT Games Ltd. Producido por TT Games con licencia de LEGO Group. LEGO, el logotipo de LEGO, NINJAGO, LEGENDS OF CHIMA, las configuraciones Brick y Knob y la Minifigura son marcas de fábrica y/o derechos de autor de LEGO Group. ©2015 The LEGO Group. Logotipo de BBC © BBC 1996. Logotipo de Doctor Who © BBC 2009. Imagen de Dalek © BBC/Terry Nation 1963. Imagen de Cyberman © BBC/Kit Pedler/Gerry Davis 1966. Imagen de K-9 © BBC/Bob Baker/Dave Martin 1977. Con licencia de BBC Worldwide Limited. ™ & © Universal Studios y U-Drive Joint Venture. ™ & © 2015 Fox. ™ & © Universal Studios y Amblin. © & ™ Valve. © Turner Entertainment Co. ™ & © WBEI. (s15). ™ & © Hanna-Barbera. (s15). Todas las marcas comerciales y los derechos de autor son propiedad de sus respectivos titulares. Todos los derechos reservados.



WB GAMES LOGO, WBIE LOGO, WB SHIELD: ™ & © Warner Bros. Entertainment Inc.  
LOGO WB GAMES, LOGO WBIE, BOUCLIER WB : ™ et © de Warner Bros. Entertainment Inc.  
LOGOTIPO de WB GAMES, LOGOTIPO de WBIE, ESCUDO de WB: ™ & © Warner Bros.  
Entertainment Inc.  
(s15)

THE LEGO MOVIE © The LEGO Group & WBEI.  
LE FILM LEGO © The LEGO Group et WBEI.  
LA GRAN AVENTURA LEGO © The LEGO Group & WBEI.  
(s15)

© New Line. ™ & © SZC lic. to WBIE.  
© New Line. ™ et © SZC lic. à WBIE.  
© New Line. ™ & © SZC con licencia de WBIE.  
(s15)



All DC characters and related indicia ™ & © DC Comics. ™ & © WBEI.  
Tous les personnages DC et toutes les marques associées ™ et © DC Comics. ™ et © WBEI.  
Todos los personajes de DC e indicios relacionados ™ & © DC Comics. ™ & © WBEI.  
(s15)